

	Dimension	Conference	Cocktail Reception	10 Person Rounds	U-Shape	Theater	Classroom	Ceiling Height
Grandview	87 x 87	-	800	490	-	750	312	14'
Grandview I	87 x 43.5	-	-	240	-	374	164	14'
Grandview II	87 x 43.5	-	-	240	-	374	164	14'
Front	29 x 43	30	100	80	26	100	60	14'
State	29 x 43	30	100	80	26	100	60	14'
Park	29 x 43	30	100	80	26	100	60	14'
Boardman	41 x 34	30	100	80	26	100	60	14'
The Gallery	27 x 26	16	65	-	-	-	-	14'
Conference A	17 x 10.5	8	-	-	-	-	-	-
Conference B	24 x 11.5	12	-	-	-	-	-	-

Please note, this chart does not reflect special set-up requirements.

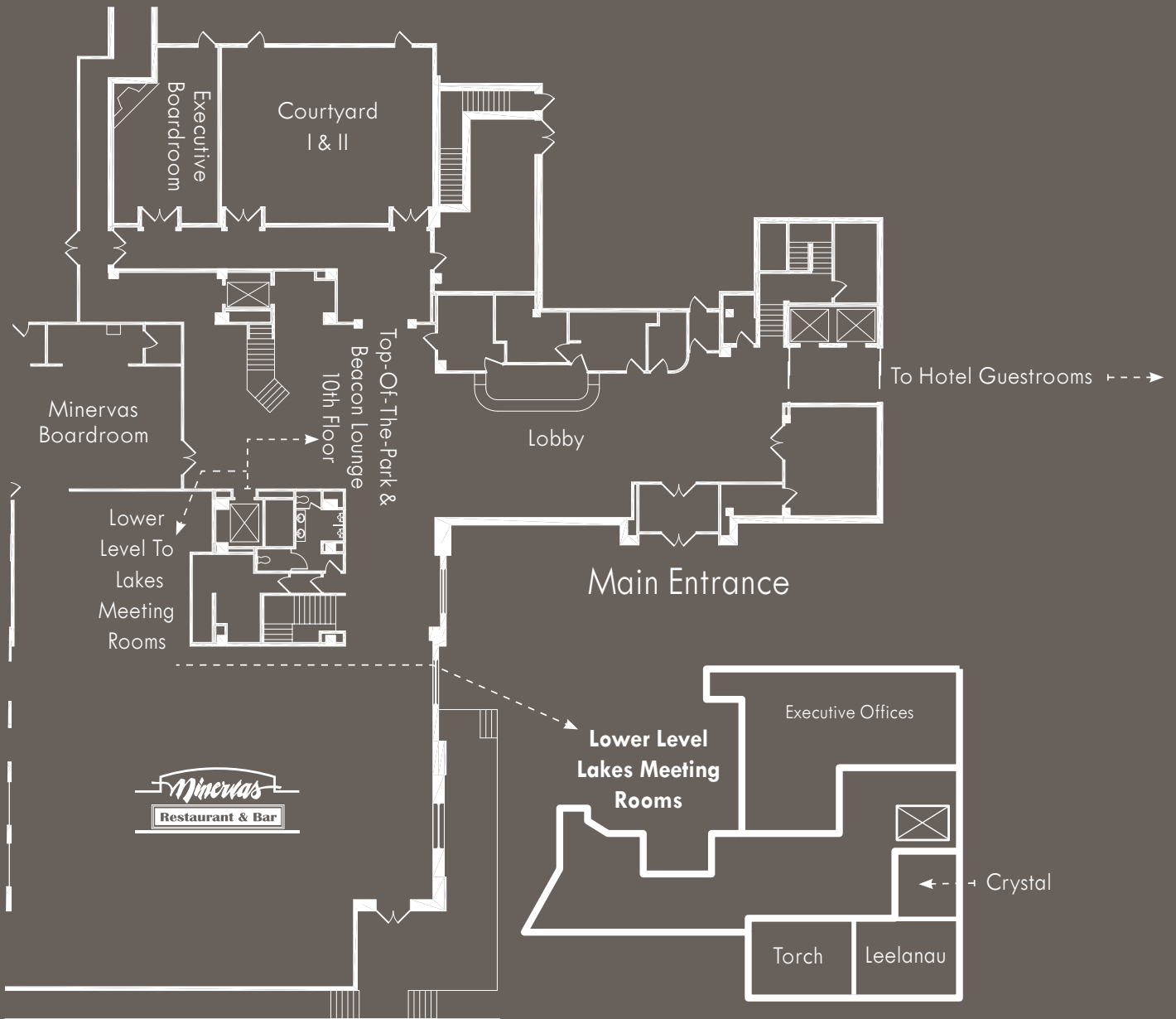

	Dimension	Conference	Cocktail Reception	10 Person Rounds	U-Shape	Theater	Classroom	Ceiling Height
Lakes	-	-	250	160	-	228	100	9'
Crystal	17 x 23	20	30	20	12	35	18	9'
Leelanau	36 x 26	30	90	70	20	100	50	9'
Torch	36 x 26	30	90	70	20	100	50	9'
Executive Boardroom	18 x 22	8	-	-	-	-	-	11'
Minervas Boardroom	12 x 41	25	50	40	16	40	20	10'
Courtyard I & II	34 x 28	30	100	60	24	100	48	11'
Courtyard I	18 x 28	15	50	30	10	50	24	11'
Courtyard II	16 x 28	15	50	30	10	50	24	11'
Top-Of-The-Park	-	30	125	80	24	50	-	8'9"

Please note, this chart does not reflect special set-up requirements.